

Creating and Incorporating a Diverse and Inclusive Culture in Schools

David Ardley
Founding Principal

Faiza Mubeen
*Director of Diversity
and Inclusion*



Beech Hall
School Riyadh

A graphic for the EMKAN School Conference 2023. It features a central illustration of three interlocking gears in shades of blue, green, and pink, set against a dark blue background with floating geometric shapes. Below the graphic, the text 'EMKAN SCHOOL CONFERENCE 2023' is written in white, followed by 'UPSKILLING IS THE FUTURE OF EDUCATION' in large, bold, white and blue letters.

EMKAN SCHOOL
CONFERENCE 2023

UPSKILLING
IS THE FUTURE
OF EDUCATION

AGENDA



- Who are we?
- Our Journey so far...
- What is Diversity & Inclusion?
- Why is there a need to develop diverse and inclusive schools?
- What are the basics of a diverse and inclusive education?
- What factors help determine the success of diverse and inclusive schools?

Who are we?



Beech Hall
School Riyadh

- **David** is Founding Principal at Beech Hall School Riyadh
- **Faiza** is the Director of Diversity and Inclusion
- Our school is brand new, in a suite of purpose-built buildings, and opened in August 2022
- We are a non-selective, international school, in partnership with the Ministry of Education working towards the #saudivision2030
- Around 70% of our parents are local Saudi

Our Journey So Far...

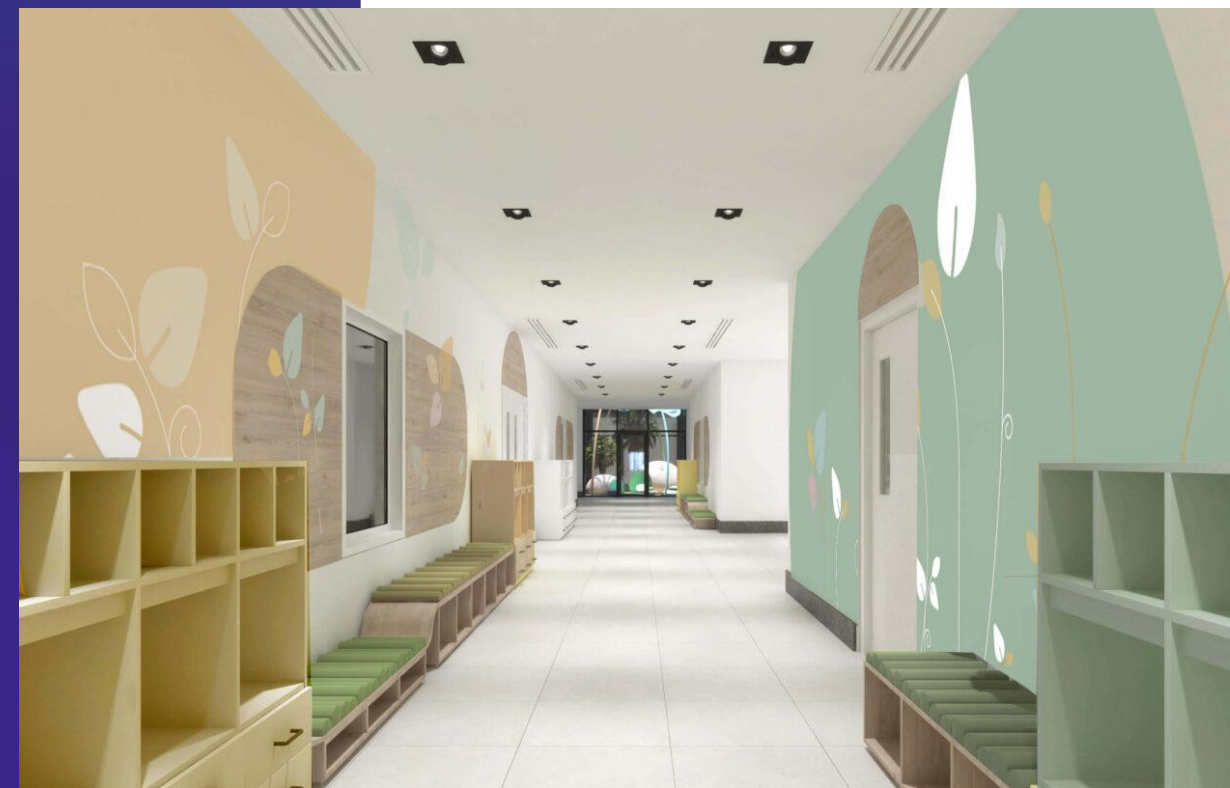

What is Diversity?

“Diversity is the practice or policy of providing equal access to opportunities and resources for all people”

This may include:

- Gifted and Talented people
- People with determination (physical or intellectually differently-abled)
- Members of other minority groups.



What exactly is a Diverse Education?



- Children with abilities and children who are differently abled are educated together in mainstream schools.
- All students in classes together having instruction in core and non-core curriculum content and participating in extracurricular activities
- All educators and specialists consult and collaborate to incorporate special support and services into an age-appropriate school and community environments
- Students are offered flexible, personalized and individualized education plans to accommodate their learning needs.
- To offer opportunities for building social networks and friendships for all children.
- Zero exclusion

Importance of a Diverse Education

A diverse education system provides:

a better-quality education

the context for a child's first relationship with the world outside their families, enabling the development of social relationships

a growth of respect and understanding when students of diverse abilities and backgrounds play socialize and learn together

respect and understanding when learning together, encouraging civic participation and employment.

an education that excludes and segregates discrimination against traditionally marginalized groups

The basic elements of a diverse and inclusive education

Use of educators, learning support specialists and counseling specialists who help teachers address the needs of all students.

A diverse and inclusive curriculum

Home school partnership and parental involvement

Supports Social-emotional learning.



Five
core
competencies

self-management
self awareness
social awareness
relationship skills
responsible decision
making

Quality Indicators of a Diverse Education



Factors that determine the success of a diverse education

Instructional practices.

Multi-disciplinary, multi-site collaboration

Student and staff support.

Family involvement

A diverse and inclusive curriculum



Closing Remarks
Thank you for listening...

Q&A



Beech Hall
School Riyadh





www.emkaneducation.com



emkaneducation



emkaneducation



emkaneducation

Copyright © 2023 by Emkan. All rights reserved.